

**NOTE: DO NOT DISCARD the Parts List from the Instruction Bulletin. Place the Parts List in the appropriate place in the machine manual for future reference. Retaining the Parts List will make it easier to reorder individual parts and will save the cost of ordering an entire kit.**

*NOTE: Numbers in parenthesis ( ) are reference numbers for parts listed in Bill of Materials.*

Installation instructions for **kit number 9015632**

### SYNOPSIS:

This kit contains the parts needed to replace the tensioner springs on M17 / T17 machines. Please follow step-by-step instructions.

### SPECIAL TOOLS / CONSIDERATIONS: NONE

(Estimated time to complete: T17 - 2 hours / M17 - 4 hours)

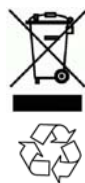

### PROTECT THE ENVIRONMENT

Please dispose of packaging materials, used machine components such as batteries and fluids in an environmentally safe way according to local waste disposal regulations.

Always remember to recycle.

### PREPARATION:

1. Empty the recovery tank and the solution tank before jacking up the machine.
2. Park the machine on a clean level surface, turn off the machine, set the parking brake, and remove the key.

**FOR SAFETY: Before leaving or servicing machine, stop on level surface, turn off machine, set parking brake, and remove key.**

3. Position steering wheel so front wheel is pointed straight out from the front of the machine.
4. Disconnect the battery cable from the machine.

**WARNING: Always disconnect battery cables from machine before working on electrical components.**

5. Remove the electrical access panel from the machine. Set the electrical access panel and mounting hardware aside. (Fig. 1)



**FIG. 1**

6. **T17 machines without optional power steering:** Disconnect the steering shaft from the input shaft. Set all hardware aside. (Fig. 3)



FIG. 2

7. **T17 machines with optional power steering and all M17 machines:** Loosen hardware and disconnect the steering shaft from the input shaft. (Fig. 4)

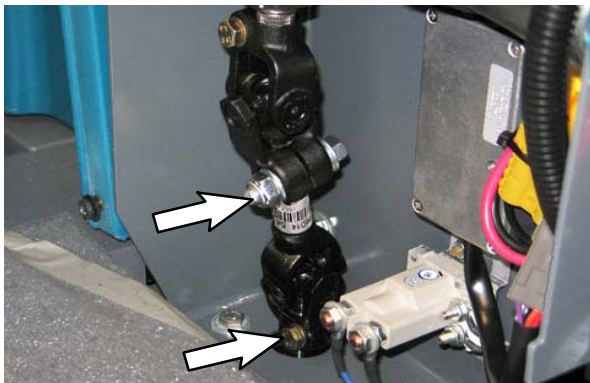

FIG. 3

8. Chock both rear tires.
9. Jack up the front end of the machine high enough to access the steering components and remove the steering components from under the machine. Place jack stands under the frame of the machine and lower the machine onto the jack stands.

**FOR SAFETY: When servicing machine, block machine tires before jacking machine up. Use a hoist or jack that will support the weight of the machine. Jack machine up at designated locations only. Support machine with jack stands.**

10. **M17 machines only:** Remove the sweep head assembly from the machine. Set the sweep head assembly and all mounting hardware / components aside.

## INSTALLATION:

1. Remove the chain from the sprockets on the the steering transmission assembly. Set the chain and both chain tensioners aside. (Fig. 5)
2. Remove the five M10 socket screws securing the input housing to the steering transmission assembly. Set the M10 socket screws aside. (Fig. 5)
3. Remove the input housing from the steering transmission assembly. Set the input housing aside. (Fig. 5)

*NOTE: If input housing is difficult to remove from the steering transmission assembly, remove the roll pin securing the input assembly and transmission shim to the steering transmission assembly. Set the roll pin aside. (Fig. 5)*

4. Remove the tensioner spring and follower pin from the input housing. Discard the tensioner spring and follower pin. (Fig. 5)
5. Insert a tensioner spring (1) into each follower pin (2). (Fig. 4)

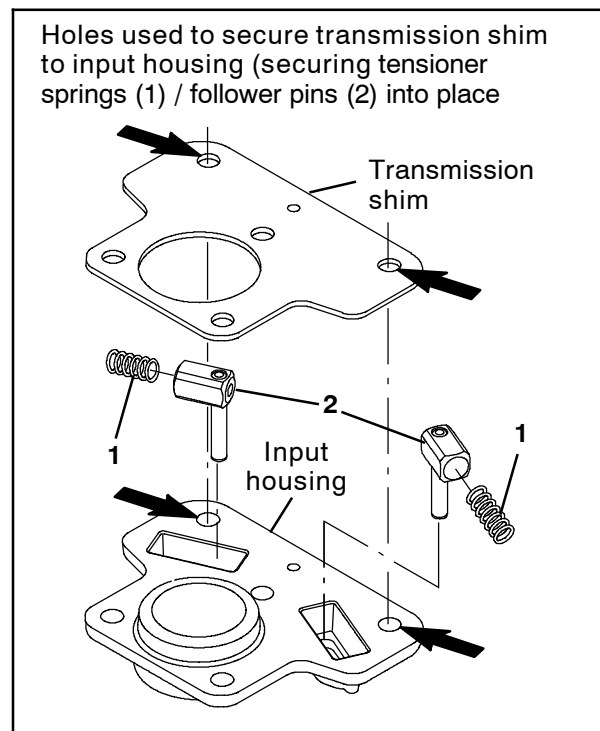

FIG. 4

6. Insert the tensioner springs (1) / follower pins (2) into the input housing, place the transmission shim onto the input housing to secure the tensioner springs (1) / follower pins (2) into the input housing, and secure all items together with a cable tie. (Fig. 4)

7. Use the five M10 socket screws to loosely install the input housing assembly onto the steering transmission assembly. **Do Not** completely tighten the M10 socket screws. (Fig. 5)
8. If roll pin was previously removed, reinstall the roll pin into the steering transmission assembly. (Fig. 5)
9. Cut the cable tie used to secure the input housing assembly together from the input housing assembly and tighten the M10 socket screws to fully secure the input housing onto the steering transmission assembly. (Fig. 5)
10. If roll pin was previously removed, carefully tap the roll pin into the input housing / steering transmission assembly. (Fig. 5)

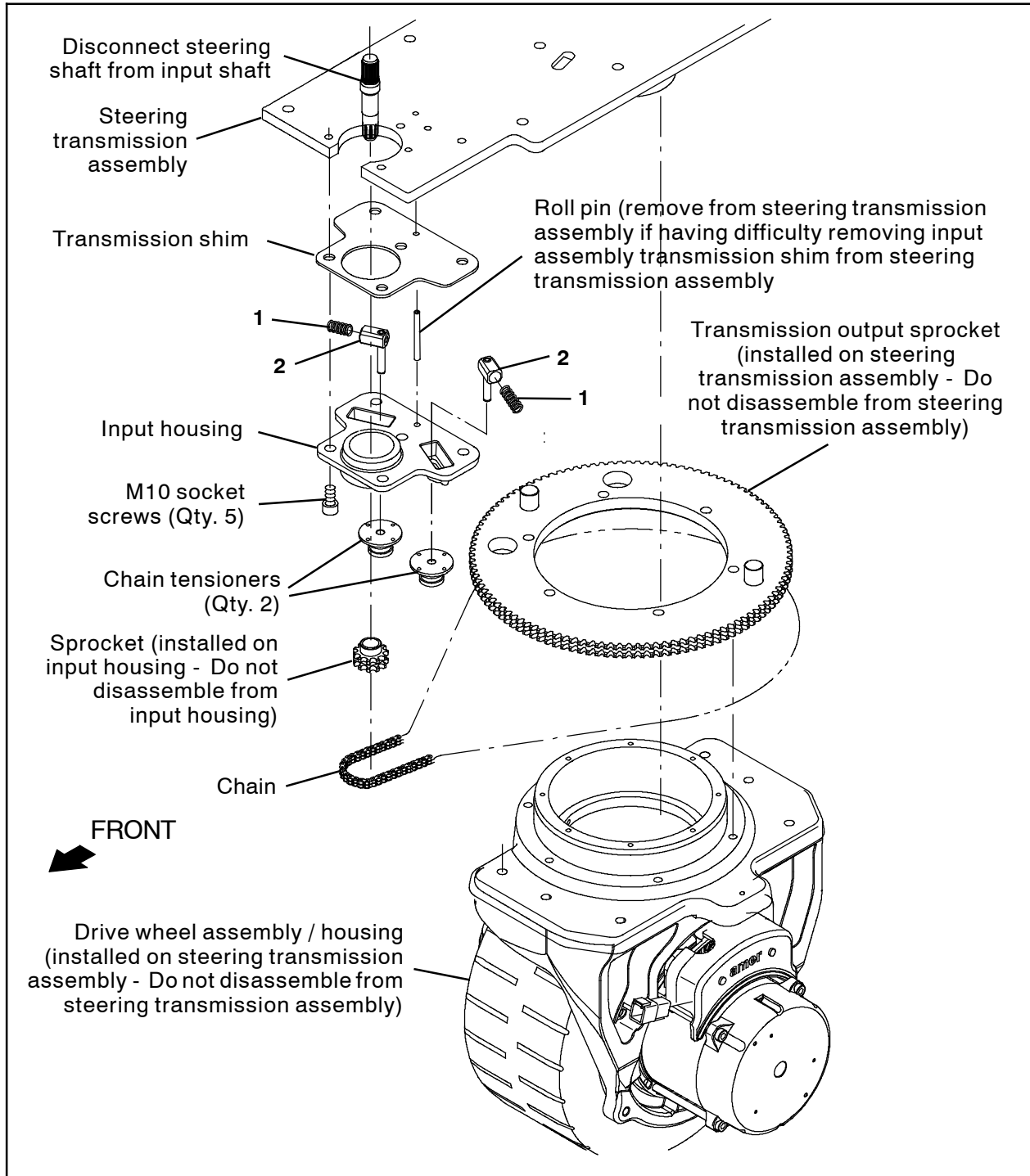

FIG. 5

11. Install the chain tensioners onto the input housing, align a hole in each chain tensioner with the holes in the input housing, and use a 3/16 rivet (or similar item) to hold each chain tensioner out on the input housing so they will not be placing tension onto the chain while it is being installed onto the sprockets. (Fig. 5 / Fig. 6)
12. Reinstall the chain onto the steering sprockets. (Fig. 5)
13. Remove the 3/16 rivet from the chain tensioners / input housing. (Fig. 5)
14. Check front wheel to be sure it is still pointed straight out from the front of the machine.
15. Reconnect the steering shaft to the input shaft. (Fig. 5 / Fig. 2 or Fig. 3)
16. Turn the steering wheel in the full range of motion in both directions. There should be no binding and the steering wheel should turn freely in both directions. (Fig. 5)
17. **M17 machines only:** Reinstall the sweep head assembly onto the machine.
18. Slightly raise machine from jack stands, remove the jack stands from under the machine, and lower the machine to the floor.
19. Reinstall the electrical access panel onto the machine.
20. Reconnect the battery cable to the machine.
21. Start and test the machine. Steering wheel should turn easily in both directions.

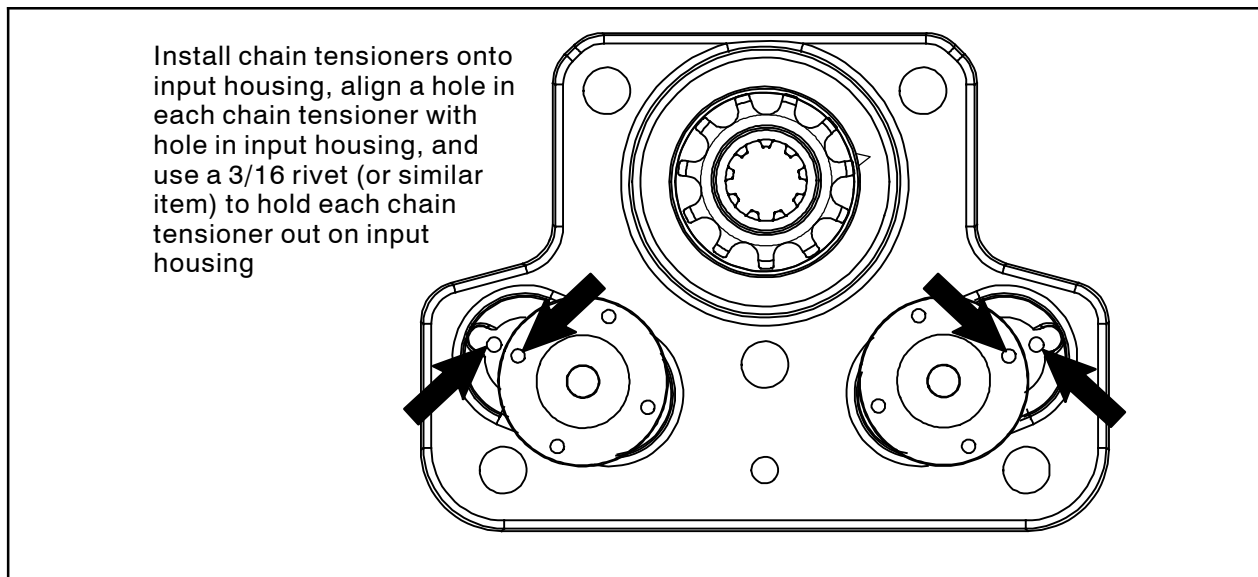

FIG. 6

Bill Of Materials For Tensioner Kit, Str Trans, Afmkt [T17/M17] - 9015632

Ref.	Tennant Part No.	Description	Qty.
1	1229426	Spring, Tensioner, Transmission	2
2	1229420	Pin Wldt, Follower	2

TENNANT COMPANY  
P. O. Box 1452  
Minneapolis, MN 55440-1452